



Copper over time

This thoroughly modern addition to an existing home in Cardiff, South Wales – discussed by Kristian Hyde of Hyde + Hyde Architects – combines copper with oak and glass in its carefully conceived design to anticipate change.

We were appointed to carefully restore elements of the existing architecture creating a contemporary yet sensitive addition to the rear. To the front of the property the new addition appears as a simple copper box 'peeping' above the layers of existing green glazed tiles of the existing home.

In the refurbishment, living and entertaining space is provided at ground floor through the introduction of a predominantly single storey glazed element. At first floor, a layered copper and oak form appears to delicately hover. Set on a shifted geometry to acknowledge the existing building form, this creates a series of overhangs, cantilevers and canopies to shelter its occupants from the persistent Welsh rain.

The original house is quirky but beautiful. The unknown architect has put a great deal of effort into the detailing, some of which is very playful. There is a certain humour about some of the spaces that continue to make our clients smile. The new addition responds with a singular oak clad curve at first floor which 'mimics' the geometry of the existing curved glazing of the main house. This is introduced to 'turn' the new addition into the main private garden at the rear.

Copper was chosen as a suitable material for facades and other details to converse with the existing 'green glazed' roof tiles of the existing dwelling. After a decade it will begin to relate in colour and tone to the existing tiles nearby, its salmon pink and russet brown tones will be gone forever. That's the beauty of copper, it's timeless and forces us to think about buildings in time. Copper's material character helps buildings feel as if they have always been there.



*“That’s the beauty of copper,
it’s timeless and forces us
to think about buildings in time”*



UPPER LEVEL PLAN

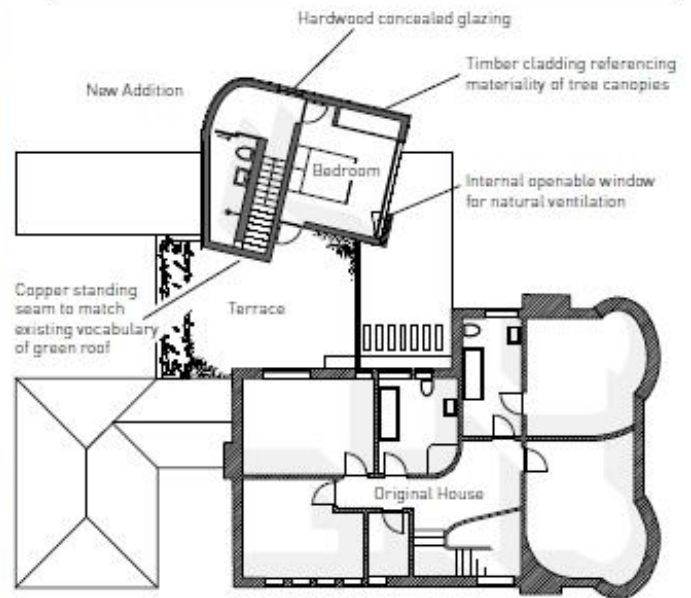

Architects: Hyde + Hyde Architects
Photos: Kristian Alexander Hyde, Warren Orchard